

Guide and Support Rail

Assembled Aluminum/UHMW/PE

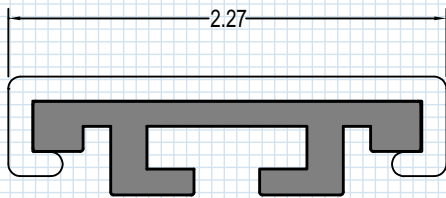

SPX 1043187
CAT AR-60-CC-025-200 ASSY
Fastens w/ 5/16" Carriage Bolt

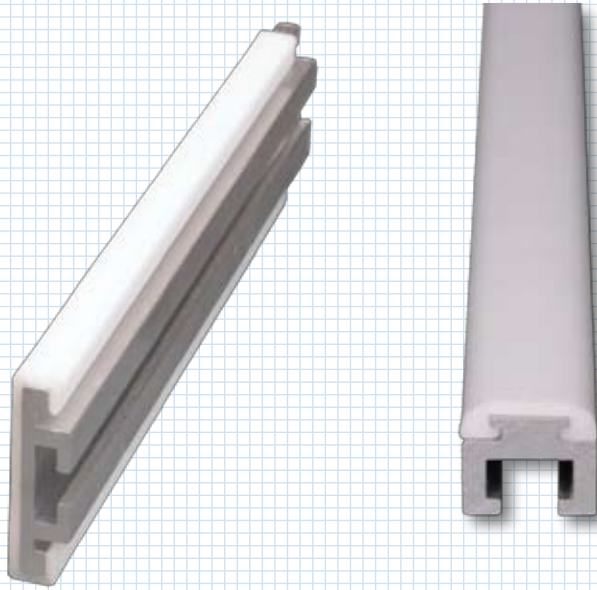
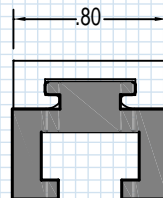

SPX 1022770
CAT AR-30-WS-03 ASSY
Fastens w/ 5/16" Hex head

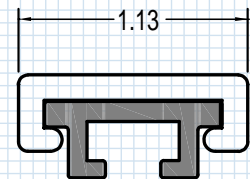

SPX 1022782
CAT AR-20-CC-012-087 ASSY
Fastens w/ 1/4" Hex head

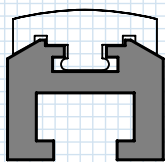

SPX 1073768
CAT AR-40-1982354 ASSY
Fastens w/ 5/16" Hex head

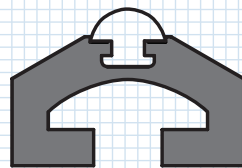

SPX 1043215
CAT AR-50-2591 ASSY
Fastens w/ 3/8" Carriage Bolt

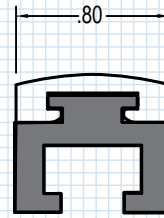

SPX 1012760
CAT AR-30-WS-02 ASSY
Fastens w/ 5/16" Hex head

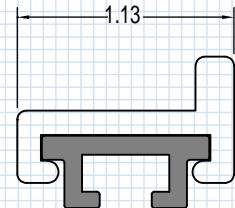

SPX 1043079
CAT AR-20-CC-012-087-F ASSY
Fastens w/ 1/4" Hex head

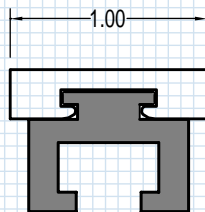

SPX 1073769
CAT AR-30-WS-04 ASSY
Fastens w/ 5/16" Hex head

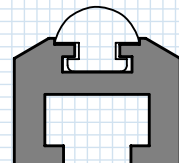

SPX 1043216
CAT AR-40-2591 ASSY
Fastens w/ 5/16" Hex head

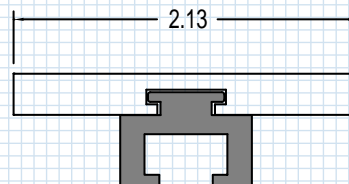

SPX 1022809
CAT AR-30-WS-06 ASSY
Fastens w/ 5/16" Hex head

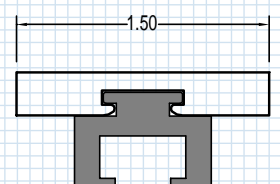

SPX 1063553/1063553
CAT AR-30-WS-05 ASSY
Fastens w/ 5/16" Hex head

Wear Covers and Inserts

UHMW/PE

- Creates a non-marring surface to guide and support
- Excellent wear resistance
- Low coefficient of friction creates anti-stick surface
- Can be assembled with Aluminum Guide Rails

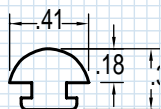

SPX 1002591 - 2591
For AR-40,AR-50 Rail

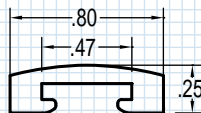

SPX 1022799
CAT WS-02
For AR-30 Rail

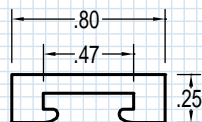

SPX 1022800
CAT WS-03
For AR-30 Rail

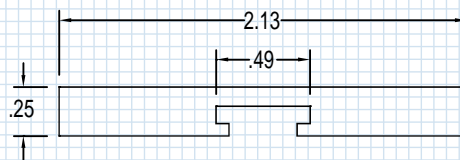

SPX 1992437
CAT WS-06
For AR-30 Rail

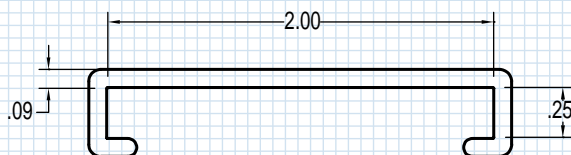

SPX 1002639
CAT CB-025-200
For AR-60 Rail

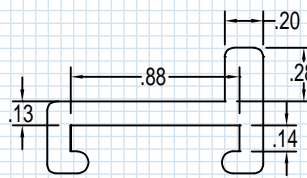

SPX 1022849
CAT CC-012-087-F
For AR-20 Rail

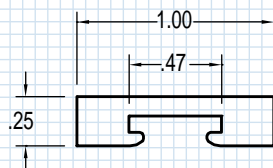

SPX 1073722
CAT WS-04
For AR-30 Rail

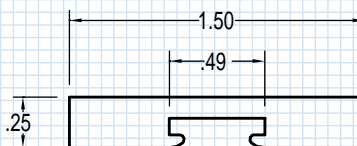

SPX 1053485
CAT WS-05
For AR-30 Rail

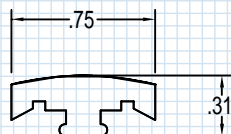

SPX 1982354
For AR-40 Rail

Guide and Support Rails Aluminum

- High quality rugged alloy aluminum
- Provides light weight structural support
- Can be assembled with UHMW/PE Wear Cover

